

NEW PRODUCTS

2022 / 2023



BOPLA

A Phoenix Mecano Company



BOPLA
enclosures ■ content matters

NEW
CONSOLE TYPE 15°

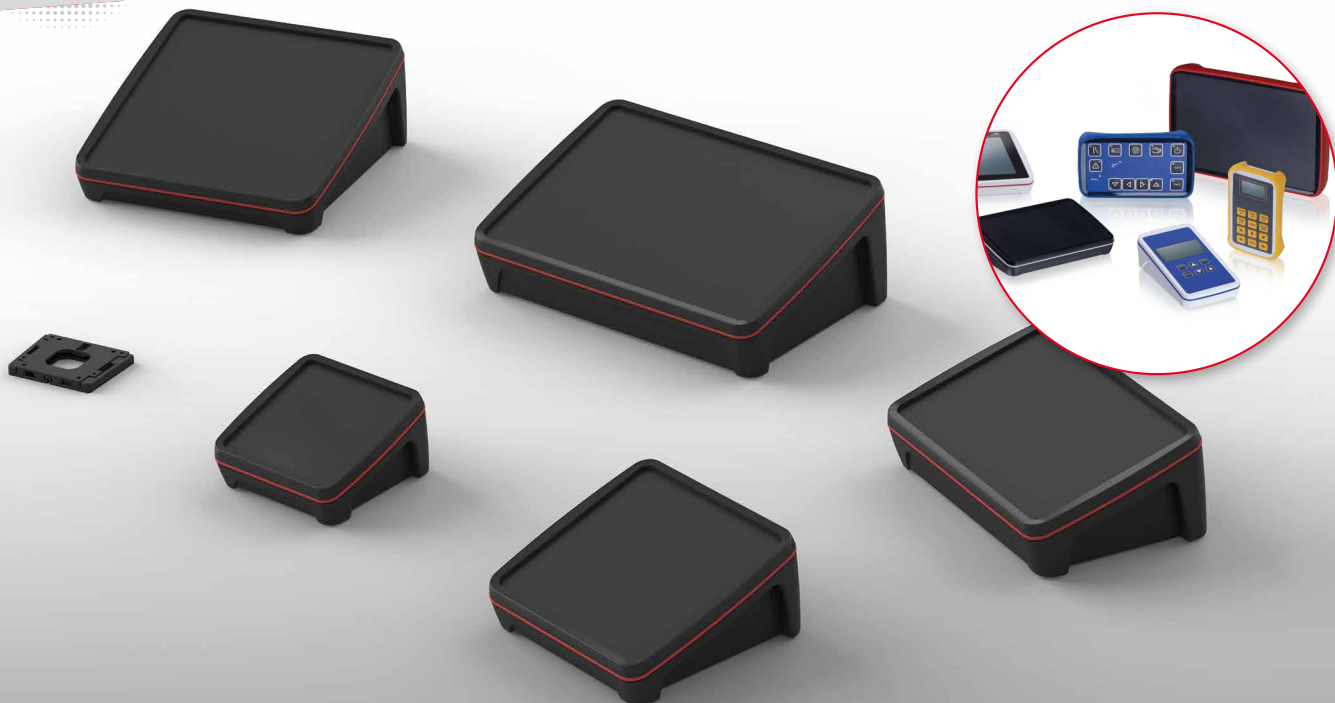

In addition to a display, square formats provide space for operating elements.



Larger interior space and steeper-angled operating surface than with previous variants.



The highly-recessed rear panel provides improved mechanical protection for interfaces.



Side-mounted recessed grips increase operating comfort.



A VESA wall fitting is now also available for small BoPad formats (and other BOPLA enclosures).



Moulded holders for current Raspberry Pi-type SBCs.

BoPad



Colour:

● Black, similar to RAL 9005

● White, similar to RAL 9016

Special Colours on request



Protection class:

IP40, with seal: IP65 DIN EN 60529



Material:

Enclosure: ABS

Seal / Impact protection: TPE

4 colour for seals (black, white, red, blue)

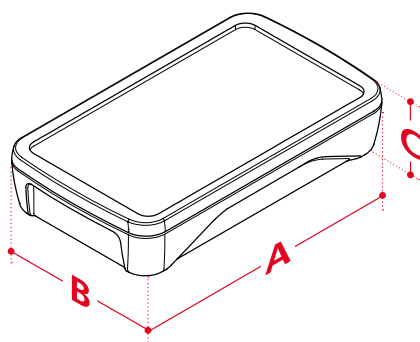

Dimensions

Model	A	B	C (Flat)	C (10°)	C (15°)
BOP 520	130	75	17.5	-	-
BOP 500	130	75	26	-	-
BOP 700	165	90	34	47.5	-
BOP 900	200	105	34	53.6	-
BOP 7.0	215	150	46	53	75.7
BOP 10.1	285	198	46	61.2	92.9
BOP 1212	122	118	-	-	57.6
BOP 1616	164	160	-	-	68.4
BOP 2222	226	220	-	-	83.7

Variants

Model	Battery compartment	Type (10°)	Type (15°)	VESA fitting	Touch/Display
BOP 520	✓			50	2.4", 2.8"
BOP 500	✓			50	2.4", 2.8"
BOP 700	✓	✓		50	3.5", 4.3"
BOP 900	✓	✓		75	3.5", 4.3", 5.0"
BOP 7.0		✓	✓	75	7"
BOP 10.1		✓	✓	75	10.1"
BOP 1212			✓	75	3.5"
BOP 1616			✓	75	5.7"
BOP 2222			✓	75	7.0"

We will be happy to carry out for you any processing required for display integration and VESA fitting.

Enclosure designs

BOP 520



BOP 500

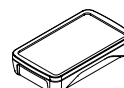

BOP 700

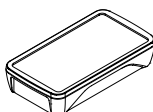

BOP 700 PH

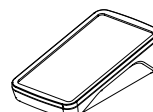

BOP 900

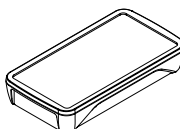

BOP 900 PH

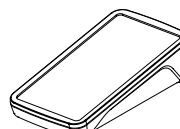

BOP 7.0

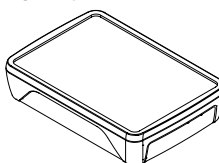

BOP 7.0 PQ

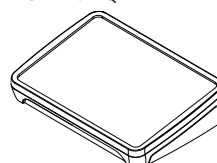

BOP 7.0 P



BOP 10.1

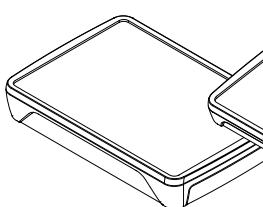

BOP 10.1 PQ

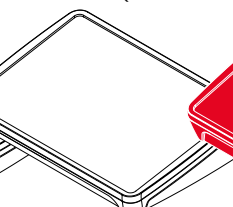

BOP 10.1 P



BOP 1212



BOP 1616



BOP 2222



Bocube Alu



Colour:

- Light grey, similar to RAL 7035
- Graphite grey, similar to RAL 7024

Special colours on request

Protection class:

IP66 / IP68 (1.2 m - 2 h) / IP69 DIN EN 60529;
Higher protection class on request

Material:

Enclosure: GD Al Si 12
Seal: PU foamed
Hinges / covers: Al Mg Si 0,5
powder-coated or
anodized in natural color



With its modern design, Bocube Alu is setting new standards in the aluminium diecast enclosure sector. In accordance with the requirements of the EU machinery directive relating to mounting, installation and maintenance, all parts are firmly attached to the enclosure.



The hinged cover is screwed on from one side and seals the enclosure to a maximum protection level of IP69. All fixing elements are concealed under a design cover.



For applications which are subjected to extremely high vibration loads, Bocube Alu is also available with a conventionally-screwed cover.

Enclosure designs

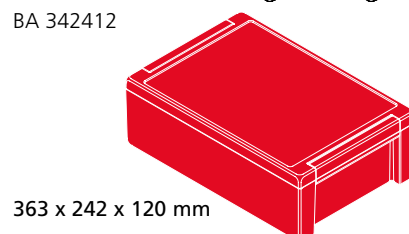
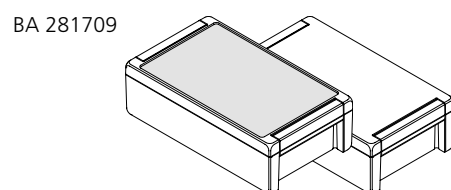
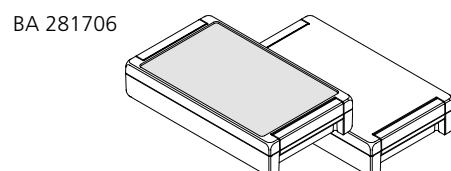
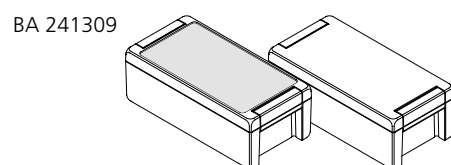
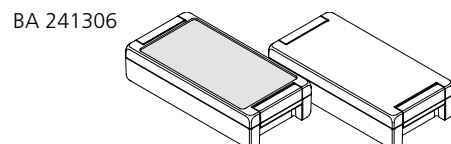
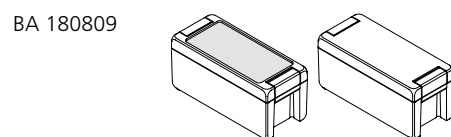
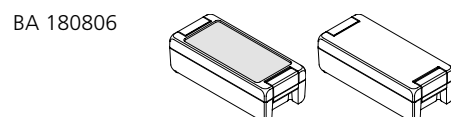
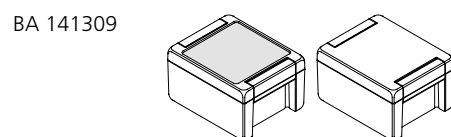
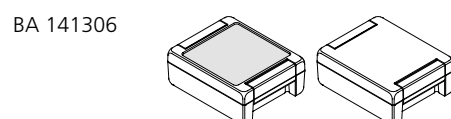
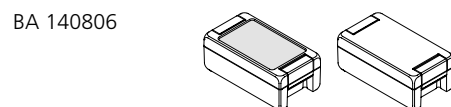
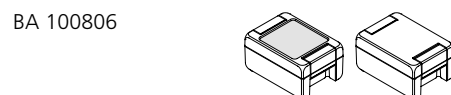

363 x 242 x 120 mm

Alu-Topline



Colour:

Profile anodized in natural color



Plastic Lid:

● Graphite grey, similar to RAL 7024

● Black, similar to RAL 9005



Special colours on request



Protection class:

ATPH: IP40; optional IP54 DIN EN 60529;

ATPH-IP: IP65 DIN EN 60529

Material:

Extruded profiles: Al Mg Si 0,5; anodized

Plastic lid: ABS

Design seal: TPE

Seal: EPDM



Enclosure designs

ATPH 1850

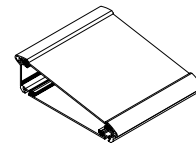

ATPH 1865

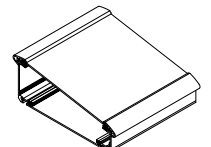

ATPH-IP 2385

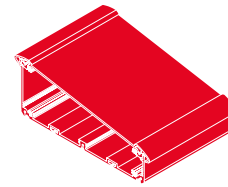

232,6 x 86,2 x C mm

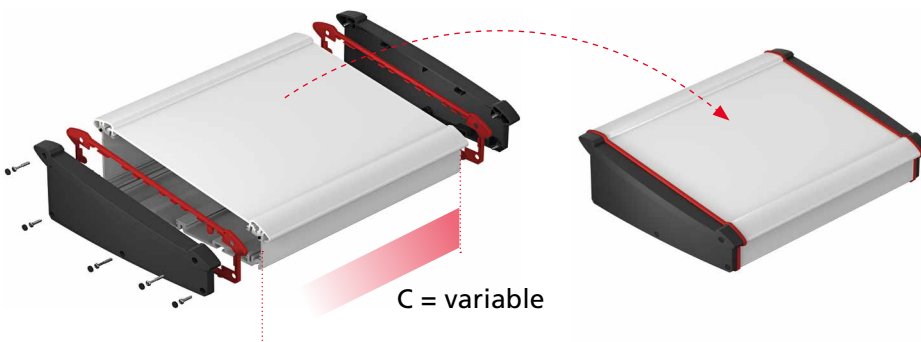

The enclosure body consists of anodised aluminium profiles and can be adapted to any application (coloured design seals only with the ATPH-IP variant).



Plastic lids are available as profile ends in two standard colours. The ATPH-IP variant also has a design seal.



The split enclosure profile allows easy access to the interior, and fast, problem-free mounting of the electronic components.

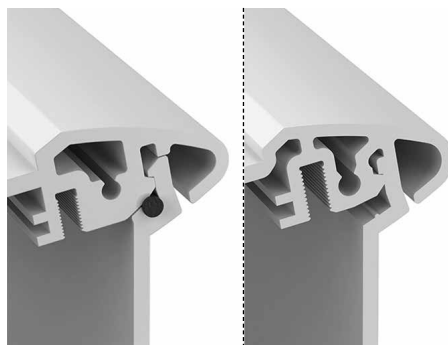

The factory-fitting of a round cord seal in combination with the AT...DI seal ensures that the ATPH variant (left) achieves protection class IP54.

The ATPH-IP version (right) provides IP65 protection as standard.



The profiles are equipped with various plug-in slots and also screw channels for alternative uses for mounting circuit boards.

ATPH 18.. = 7.0", ATPH-IP 2385 = 10.1".

The product advantages



Euromas X adds new formats and functions to the classic EUROMAS range. Available in ABS and polycarbonate material variants.



PC variants with an injection-moulded seal provide protection class IP66/68; ABS IP65.



Numerous designs are equipped with directly moulded-on wall brackets.



Euromas X enclosures have a recessed area for fitting membrane keypads or display screens.



The lid screws – secured against falling out – are screwed into high-quality threaded bushings.



Circuit boards can be securely fixed in the base by means of screw domes.

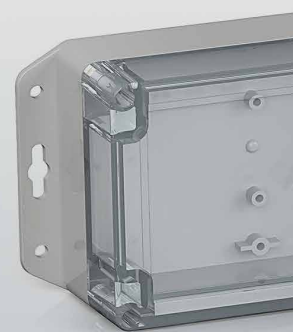



BOPLA

A Phoenix Mecano Company

Euromas X



Colour:

● Light grey, similar to RAL 7035

Special colours on request

Protection class:

PC variants: IP66 / IP68 (1.2 m - 2 h) DIN EN 60529

ABS variants: IP65 DIN EN 60529

Impact resistance: IK07 acc. to IEC 62262

Material:

Enclosure: ABS (XT) or PC (XM)

Seal: CR bei ABS; PU for PC



Enclosure designs

XM / XT 110704

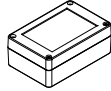

XM / XT 111106

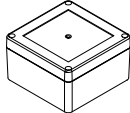

XM / XT 111108

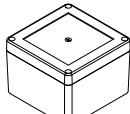

XM / XT 130804

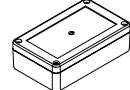

XM / XT 141406

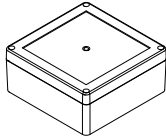

XM / XT 151006

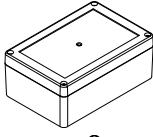

XM / XT 151008

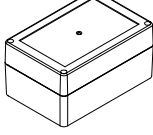

XM / XT 151506

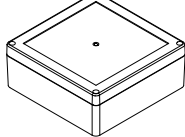

XM / XT 181209

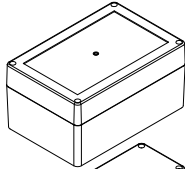

XM / XT 190808

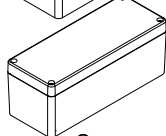

XM / XT 211406

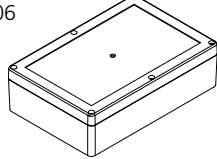

XM / XT 241911

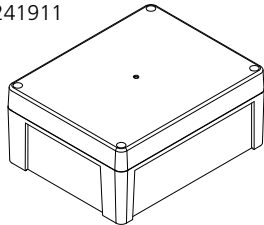

XM / XT 050504 WL



XM / XT 060604 WL



XM / XT 090604 WL

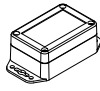

XM / XT 110704 WL

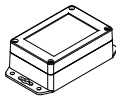

XM / XT 120805 WL

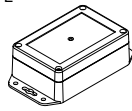

XM / XT 120806 WL

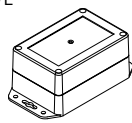

XM / XT 151005 WL

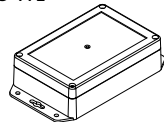

XM / XT 151006 WL

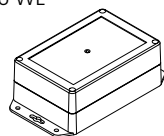

XM / XT 181206 WL

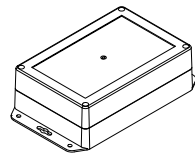

XM / XT 211405 WL

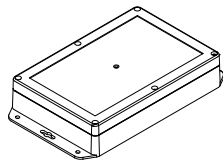

Design types

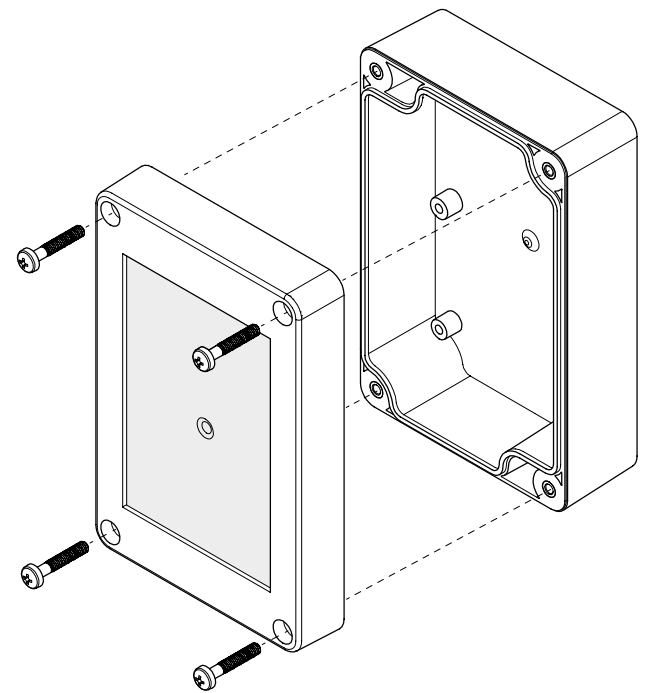
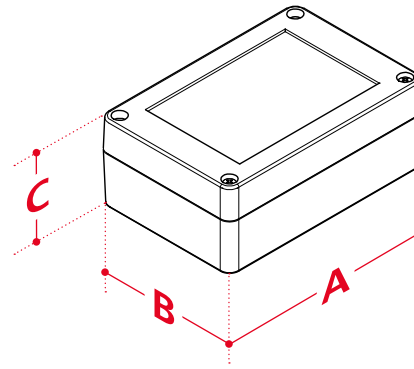

Crystal-clear cover (G)

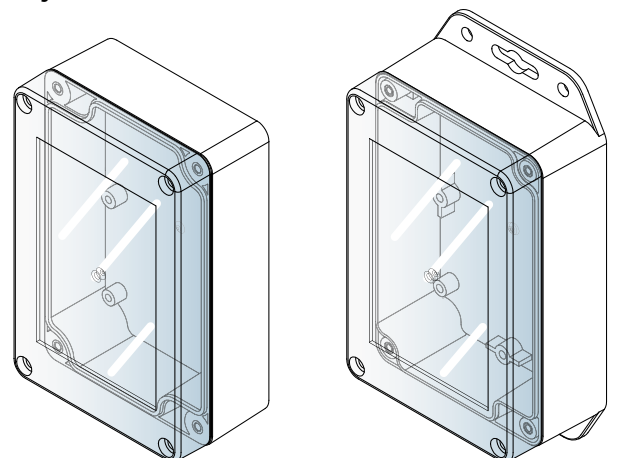

Euromas X

Enclosure with moulded-on wall brackets (WL)

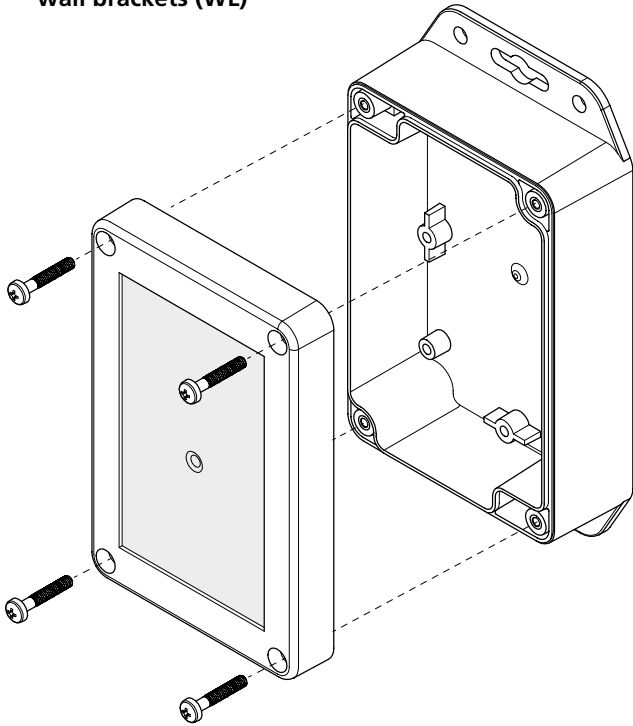

Dimensions

Model	A	B	C
XM (G) / XT 110704	105	70	40
XM (G) / XT 111106	105	105	60.1
XM (G) / XT 111108	104.8	104.8	74.7
XM (G) / XT 130804	125	75	37.2
XM (G) / XT 141406	134.7	134.7	60.1
XM (G) / XT 151006	150	100	60
XM (G) / XT 151008	150	100	75
XM (G) / XT 151506	149.9	149.9	60
XM (G) / XT 181209	180	120	90.3
XM (G) / XT 190808	191.8	75.1	75.3
XM (G) / XT 211406	209.7	139.8	60.1
XM (G) / XT 241911	240	191.3	105.6

With wall brackets

XM (G) / XT 050504 WL	45.9	46	40.1
XM (G) / XT 060604 WL	61.1	61.3	40
XM (G) / XT 090604 WL	91.1	61.3	39.9
XM (G) / XT 110704 WL	105.2	71.3	40
XM (G) / XT 120805 WL	121.4	81.5	45.2
XM (G) / XT 120806 WL	121.4	81.5	60.2
XM (G) / XT 151005 WL	151.4	101.5	45
XM (G) / XT 151006 WL	151.4	100	60
XM (G) / XT 181206 WL	181.3	94.9	60.2
XM (G) / XT 211405 WL	211.1	141.3	45.1

Accessories



DIN rails
TH 15, TH 35

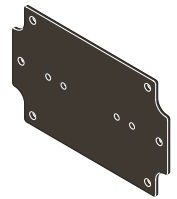

Mounting panels in different versions



Mast mounting on demand



General accessories

Mast brackets for industrial enclosures



Five sizes for our huge industrial enclosure portfolio

The modular system consists of a mast bracket, a set of screws and a sleeve. Only 5 different mast bracket variants are required for BOPLA's entire industrial enclosure portfolio, which consists of several hundred enclosure sizes and versions. The alignment of the enclosures is unimportant – mounting can take place both vertically and horizontally.

This flexibility is achieved by means of an intelligent arrangement of the drill hole diameters and positions, in addition to the partial use of slots.

Specially-matched mast brackets are also available for our POLYSAFE polyester switch cabinet system.

Suitable for enclosure series:

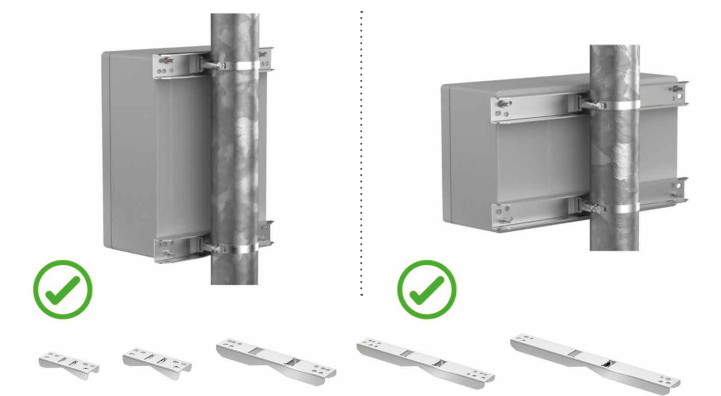

Wall fitting to VESA standard



Our wall fittings with their VESA-compatible drilling hole pattern allow easy, reliable mounting of a BOPLA enclosure on walls, control panels or machine enclosures. Thanks to their very low installation height, they are almost invisible when fitted. As universal accessories, they can be used in coordination with almost all BOPLA enclosures, if necessary after suitable mechanical processing.

VESA 50

VESA 75

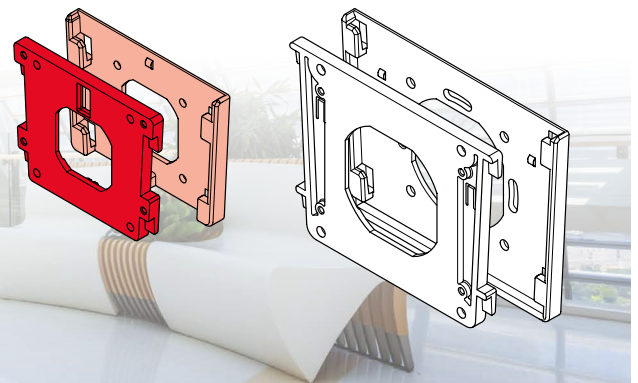

Ventilation elements

These ventilation elements prevent the formation of condensation in enclosures used in varying climatic environments. They make possible unrestricted high air flow, so they are the right choice especially for large-volume enclosures.

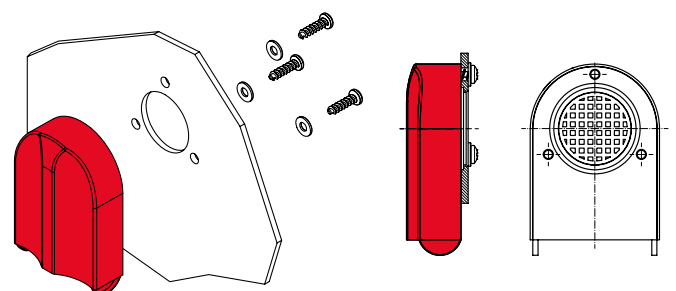
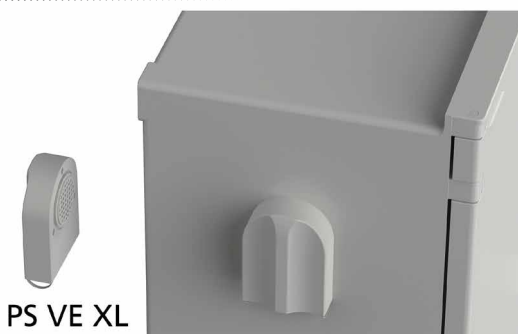
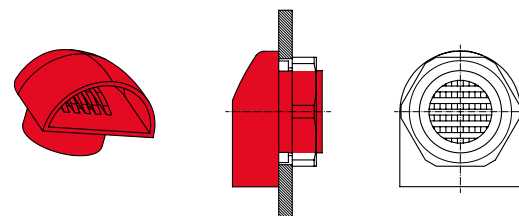
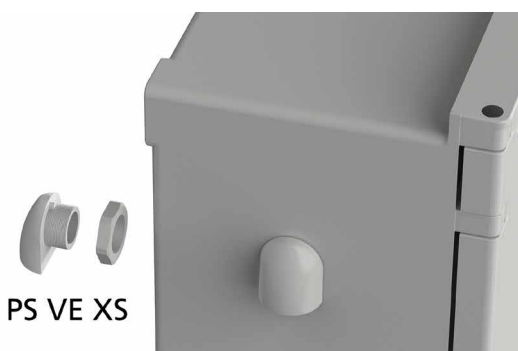



A Phoenix Mecano Company

Bopla Gehäuse Systeme GmbH
Borsigstraße 17-25 | D-32257 Bünde
Tel. +49 (0) 5223-969-0 | Fax +49 (0) 5223-969-100
info@bopla.de | www.bopla.de

A data download can be found at: www.bopla.de



Mat.-Nr. 88112207 2022/10
English