

TECHNICAL DATA:

General Data

Force	Max. 500 N
Speed adjustment	Max. 38 mm/s
Stroke length	Min. 30mm – max. 100mm or Min. 1mm – max. 70mm
Installation dimension (G)	138mm (Typ M10) 238mm (Typ LH10) 270mm (Typ LH11, LH950)
Duty cycle	40%
Position feedback	Optional
Supply voltage	12VDC, 24VDC
Intergrated limit switch	Yes
End position signal	Optional
Protection class	IP54 or IP40 (static)
Self-locking	Up to nominal load
Storage temperature	-20°C to +80°C

Components

Rod end	Eye bold, steel anodized
Housing end	Integrated M6 thread
Lift tube material	Stainless steel or POM
Housing material	Die-cast aluminum, anodized aluminum profile
Connection	Cable
Cable length	1,5m
Options	Suspensions individually selectable Special strokes adjustable ex works Special strokes adjustable by customer

More data

Control / Regulation	Voltage polarity
Position feedback	End position feedback potential bound End position feedback potential-free Potentiometer

TECHNICAL DRAWING:

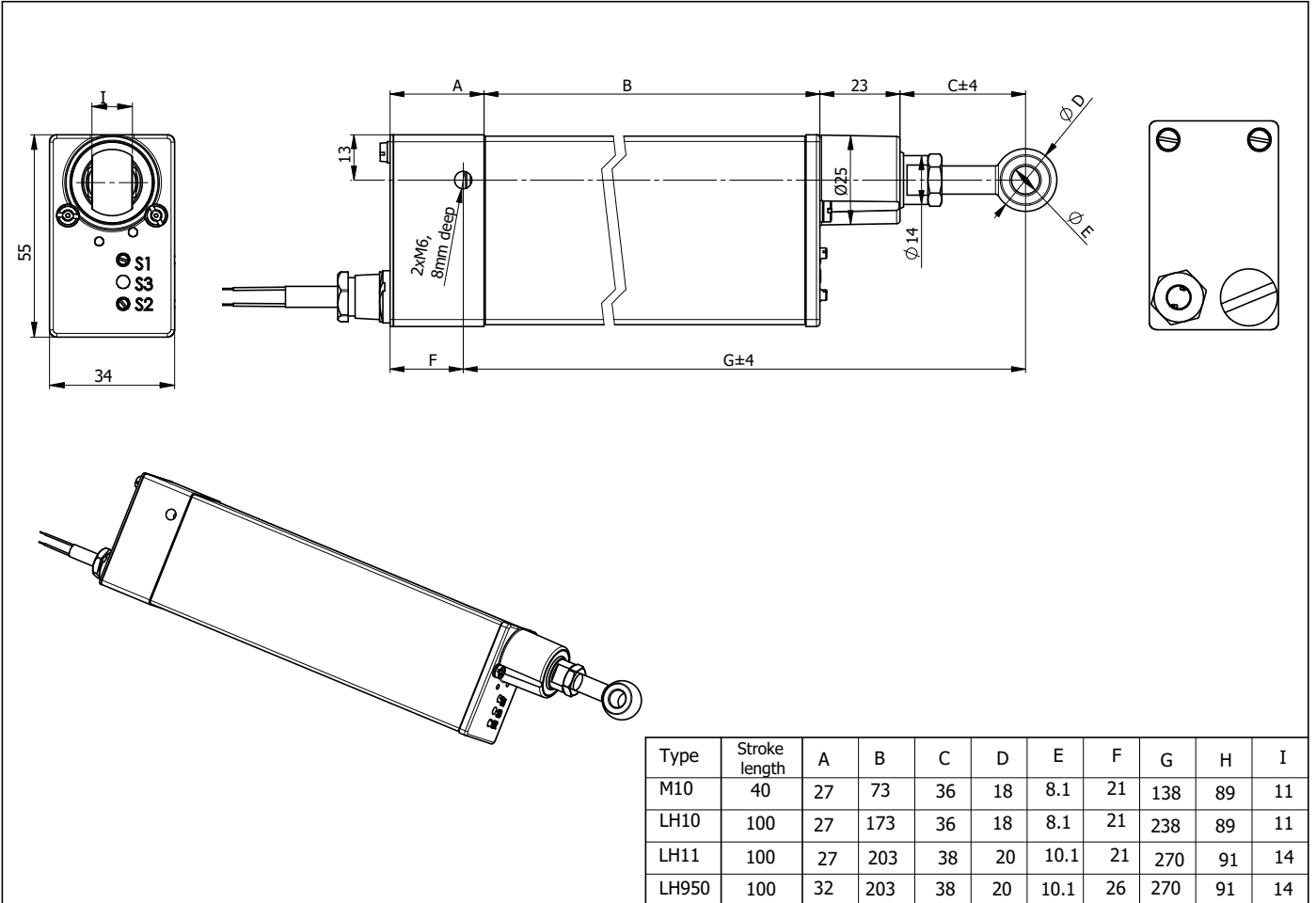



PERFORMANCE DATA

